

PART NO.	CONDUCTOR MATERIAL	CURRENT
FA11669	COPPER	55 AMPS
FA11669-02	MOLYBDENUM	28 AMPS
FA11669-03	NICKEL	16.5 AMPS
FA11669-04	304 STN STL	3.6 AMPS

RATINGS	
VOLTAGE:	5KV DC
CURRENT:	SEE TABLE AT LEFT
TEMPERATURE:	-269°C TO 450°C

PROPRIETARY AND CONFIDENTIAL

THE INFORMATION CONTAINED IN THIS DRAWING IS THE SOLE PROPERTY OF SOLID SEALING TECHNOLOGY. ANY REPRODUCTION IN PART OR AS A WHOLE WITHOUT THE WRITTEN PERMISSION OF SOLID SEALING TECHNOLOGY IS PROHIBITED.

THIRD ANGLE PROJECTION

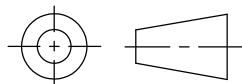

TITLE:

THREE 5KV FEEDTHROUGHS



**SOLID SEALING TECHNOLOGY, INC.**

REV.	APP'D	DATE	SCALE 1:1	DIMENSIONS IN INCHES [mm]	DRAWN	JM	12/28/2005
A1	MH	04/28/2006	MPST0015-0ST		ENG APPR.	MH	04/28/2006

PART NO. (SEE TABLE) REV. A

SALES DWG NO. FA11669SL REV. A1